

A - EXISTING
655-2: 36 (18 TABLES)
655-3: 20 (10 TABLES)

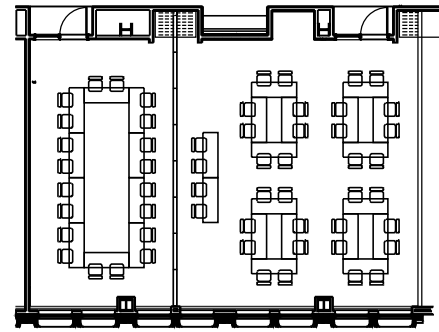

B - BANQUET GROUPS OF 8
655-2: 36
655-3: 20

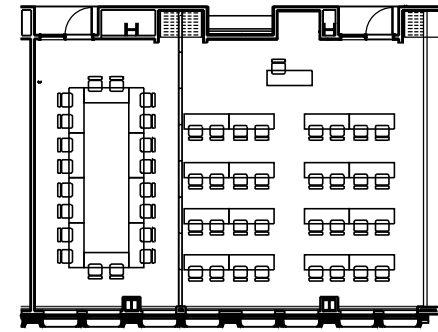

C - CLASSROOM
655-2: 32
655-3: 20

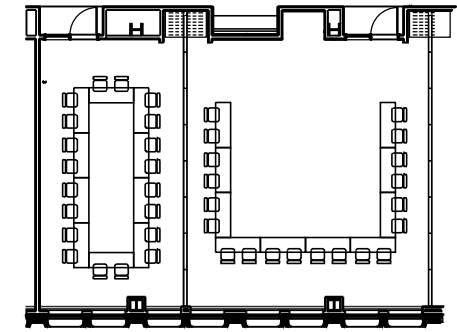

D - U-SHAPE
655-2: 20
655-3: 20

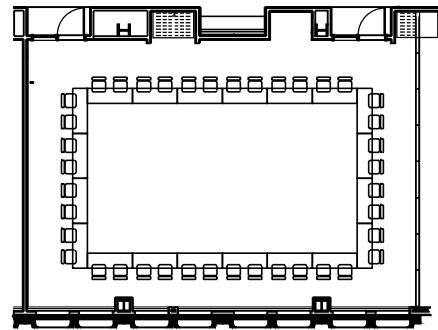

E - HOLLOW RECTANGLE
655-2, 655-3: 40

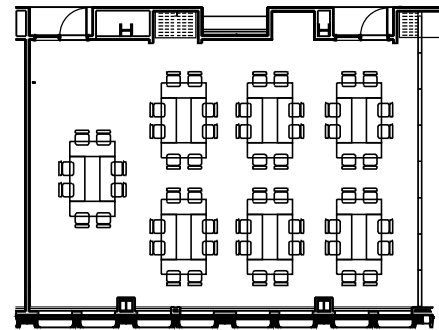

F - BANQUET GROUPS OF 8 + HEAD TABLE
655-2, 655-3: 56

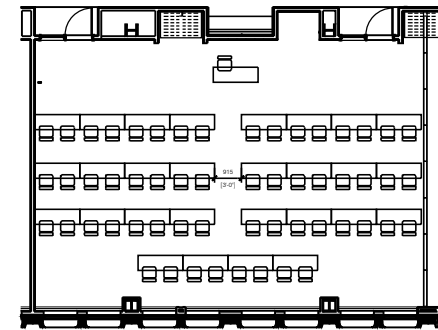

G - CLASSROOM
655-2, 655-3: 64

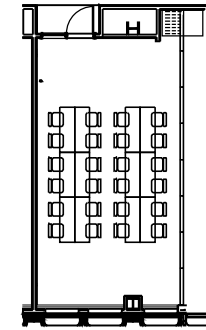

H - BANQUET GROUPS OF 8 AND 12
655-3: 24

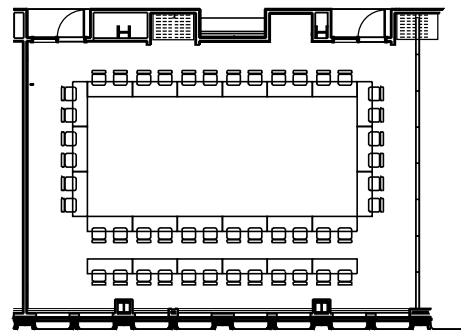

I - HOLLOW RECTANGLE WITH BACK BENCHERS
655-2, 655-3: 36 + 12 = 48

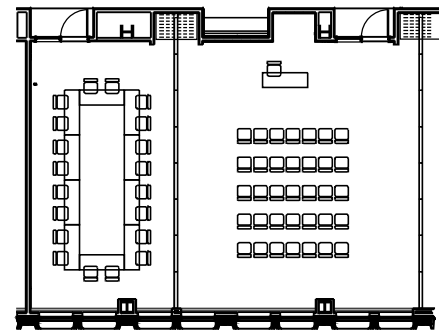

K - MEETING + THEATRE
655-2: 36
655-3: 20

Architecture et Design Intérieur

PROVENCHER_ROY

PROVENCHER ROY DESIGN INTÉRIEUR INC.
276, RUE SAINT-JACQUES, BUREAU 700
MONTRÉAL, QUÉBEC, CANADA H2Y 1N3
T 514 844.3938
F 514 844.6526
PROVENCHERROY.CA

sceau

projet

CONCORDIA H6
MOBILIER LOCAUX 655-2, 655-3

titre du dessin

QUANTITÉS EXISTANTES
AMÉNAGEMENTS POSSIBLES - DoS, LIVE, SARC, ASRC

adresse

étage
H6

01	2021-08-09	COORDINATION CLIENT
numéro	date	émissions / révisions

numéro du projet

180102

échelle

N/A

dessiné par

A-S.V.

approuvé par

R.N.

date

2021-08-09

référence

000

no dessin

A-1

révision 01